

Installation Instructions

U15 Ultimate doorset



Tel 01522 693522 Fax 01522 508494
www.doortechinik.co.uk

To install DoorTechnik U15 doorsets correctly and safely, please read these instructions before starting the installation. Long Allen keys >220mm, long drills and long driver bits are needed to reach through the lock jamb.

Warning: do not open the door until the first fixings are in place, after step 5

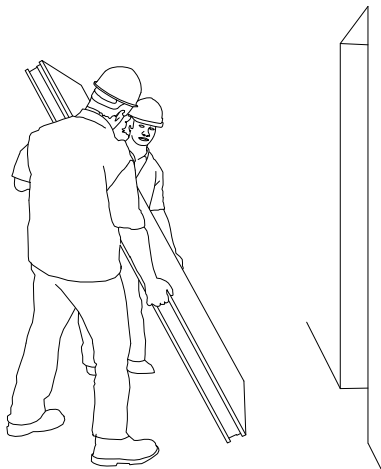

1. Place the doorset in the opening.

Lift by the handgrips or trays in the frame – never by pull handles on the door leaf.

Weight warning: comply with local manual handling guidelines.

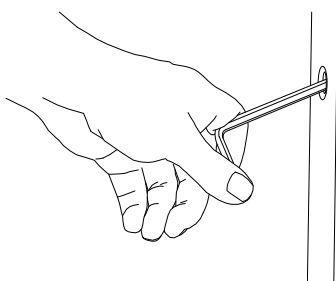

3. Tighten the frame adjusters clockwise, with a 5mm ball-ended Allen key, until the ends of the spreader plates are flat against the wall.

Access is gained through the holes in the jambs, angling the key 20° from horizontal.

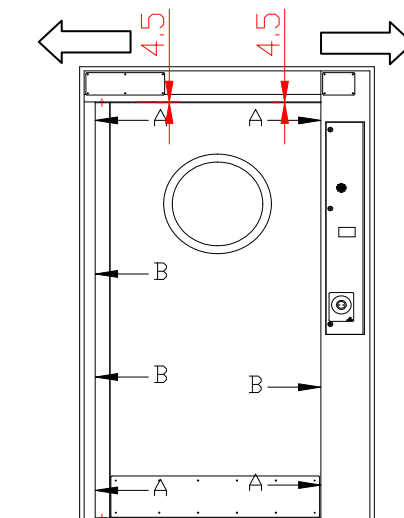

Gap between top of door and underside of head must be equal each side. Adjust by moving top of frame sideways.

Fit shims under jambs and threshold if floor is not level.

2. Working from the push side of the door, align and grip the doorset in the opening, using the frame adjusting screws A in the corners.

Using diagonal corner adjusters, move the top of the frame left or right until the head gap is parallel.

Do not over tighten the 3 middle adjusters B.

4a. In the forwards and backwards plane, ensure the frame is aligned vertically, and not leaning in or out of the building.

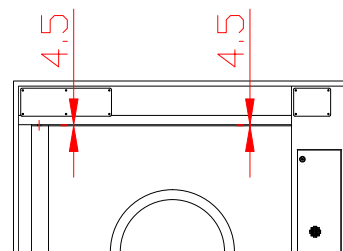

4b. In the side to side plane, the parallel head gap aligned in step 2 takes priority, so the jambs may well not be quite vertical.

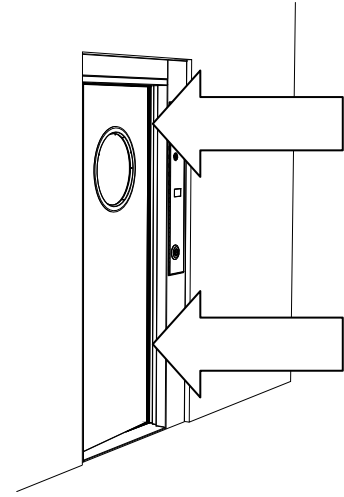
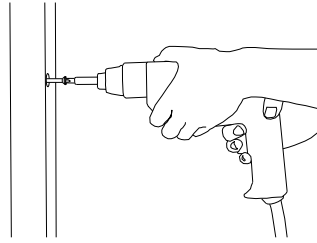
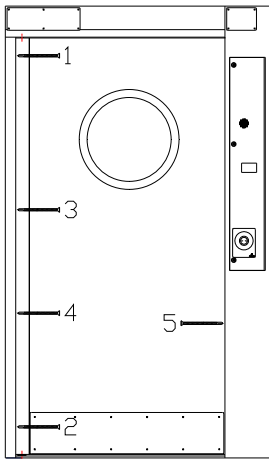

5. First fix as shown, with 4 fixings in the hinge jamb and 1 in the lock jamb.

Vibration from a hammer drill can loosen the frame adjusting screws, so re-check tightness of the adjusters prior to inserting masonry fixings.

6. Open the door and discard the transit packings. With the door nearly closed, check the alignment between the lock edge of the door and the frame seal, at both the top and the bottom of the door.

Pivot the lock jamb about the central fixing to achieve a parallel gap between the face of the door and the frame seal. The lock jamb may well not be quite vertical, but the parallel seal gap takes priority.

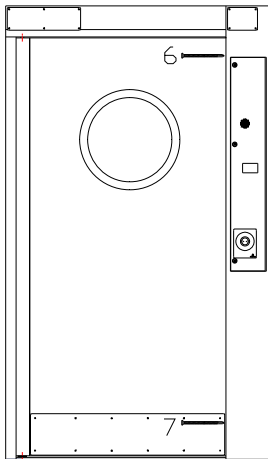

7. Close the door again, then fit 2 fixings into face 5 of the lock jamb.

8. Open the door fully, tighten the frame adjusters in the reveals on the lock jamb, then fit the last 3 frame fixings.

9. Fix threshold to floor with countersunk screws.

10. Adjust the door closer to suit the on-site requirements, referring to the separate instruction sheet for full details. Check that the door opens and closes freely without obstructions.

11. Check operation of the deadlock.

12. Apply mastic to seal frame to the building.

13. Seal threshold to floor to avoid water ingress.