

Installation Instructions

E12 single doorsets



Tel 01522 693522
www.doortechnik.co.uk

To install DoorTechnik doorsets correctly and safely, please read these instructions before starting the installation.

Fire rated doorsets must be sealed as described in Step 11 to comply with the as-tested fire certification.

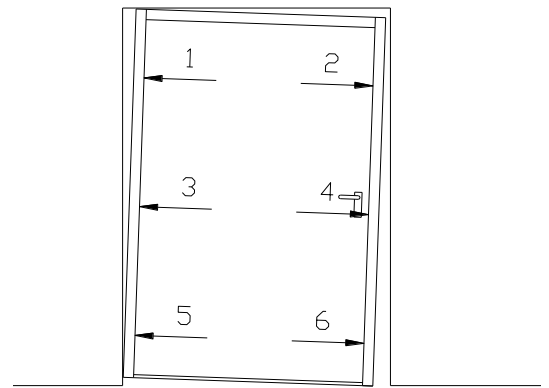
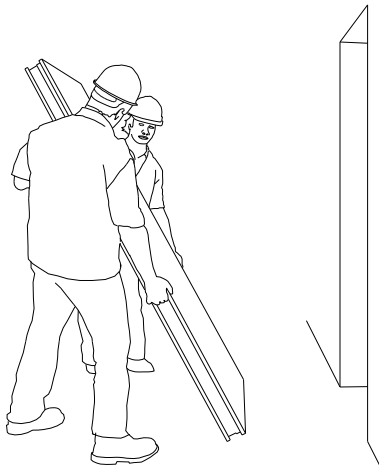

1. Place the doorset in the opening.

Lift by the handgrips in the frame – never by lever handles, panic bars or letterboxes etc.

Weight warning: comply with local manual handling guidelines.

2a. Align and grip the doorset in the opening, using external packings.

If the floor is not level, fit packers under the frame and threshold.

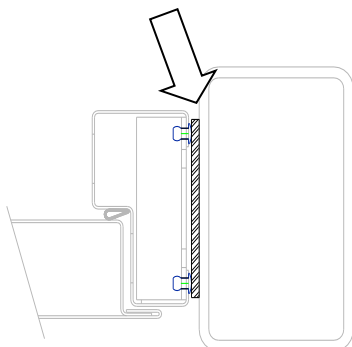

2b. Fitting external packings between the jambs and the structural opening.

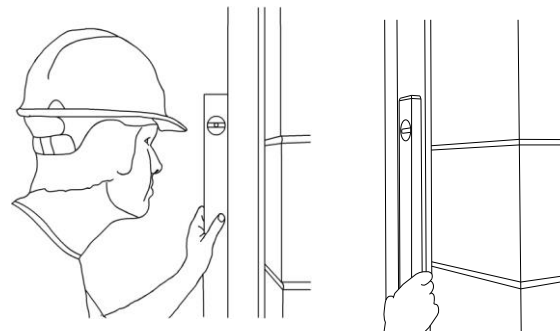

3. Ensure the frame is vertical in both planes, particularly the hinge jamb.

Warning: do not open the door until first fixings are in place, after step 4.

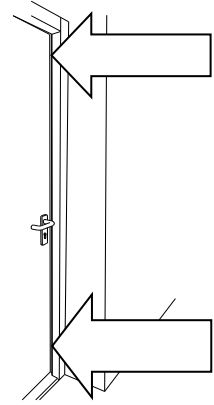
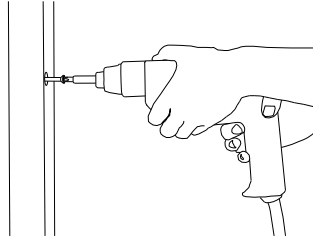
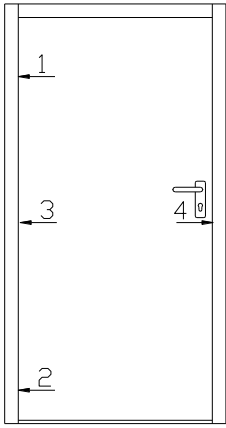

4. Keeping the door closed, and working from the push side of the door, first fix as shown, with 3 fixings in the hinge jamb and 1 in the lock jamb.

- For steel, use ITW Buildex TFL 65 or similar.
- For masonry, use Rawl frame fixings 8x60 or similar.

5. Open the door and discard the transit packings. With the door nearly closed, check the alignment between the lock edge of the door and the frame seal, at both the top and the bottom of the door.

Pivot the lock jamb about the central fixing to achieve an even gap between the face of the door and the frame seal.

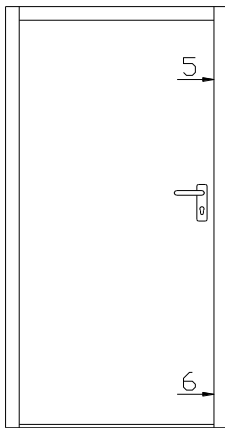

6. Close the door again, then fit the last 2 fixings into face 5 of the lock jamb.

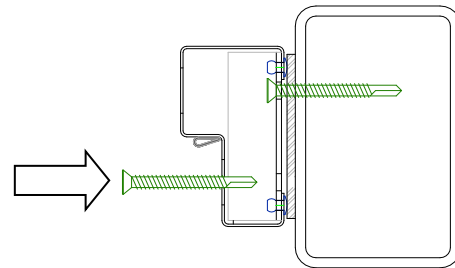

7. Open the door again, then second fix through the access holes in the frame reveals.

- For steel, use ITW Buildex TFL 65 or similar.
- For masonry, use Rawl frame fixings 8x60 or similar.

8. Fix threshold to floor with countersunk screws

- For steel, use ITW Buildex TFL 65 or similar.
- For masonry, use Rawl frame fixings 8x60 or similar.

9. Seal threshold to floor to avoid water ingress.

10. Adjust any door closers to suit the on-site requirements. Refer to separate instruction sheet for full details.

11. Check operation of all locking mechanisms.

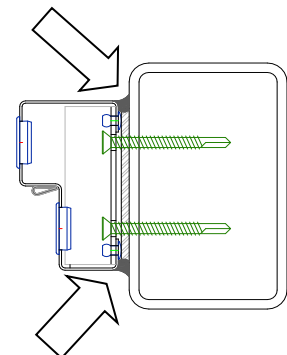

12. Apply mastic or flashings to seal frame to building. Fit blanking plugs to the frame fix access holes.