

Installation Instructions

Security rated single doorsets X15 and X20

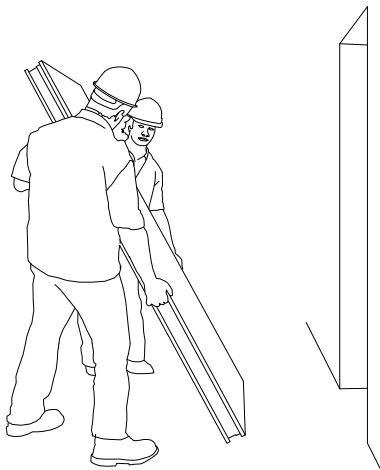

To install DoorTechnik X-series security doorsets correctly and safely, please read these instructions before starting the installation. To comply with the as-tested security certification, take particular note of the fitting clearances in Step 2, the frame setback shown in Step 9, and the use of approved frame fixings in Step 9 and Step 10. Please note: These instructions only apply to doorsets fitting into structural steelwork.



1. Place the doorset in the opening.

Lift by the handgrips in the frame – never by lever handles, panic bars or letterboxes etc.

Weight warning: comply with local manual handling guidelines.

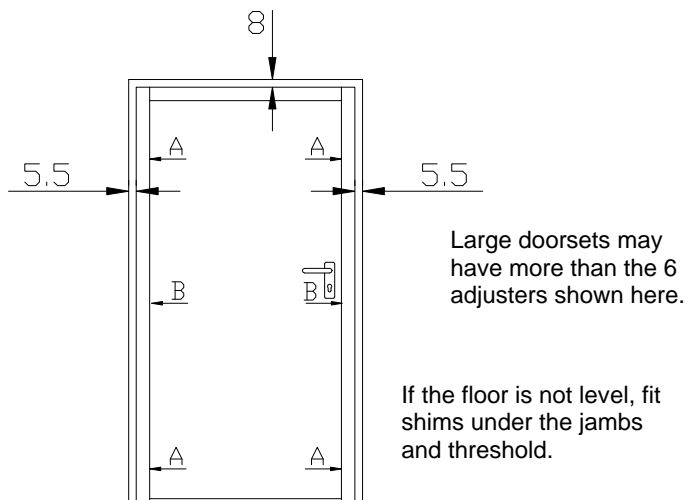

2. Align and grip the doorset in the opening, using the frame adjusting screws A in the corners, then the middle adjusters B.

Note the maximum fitting clearances as shown above.

Set the hinge jamb back into the wall as shown in Step 9.

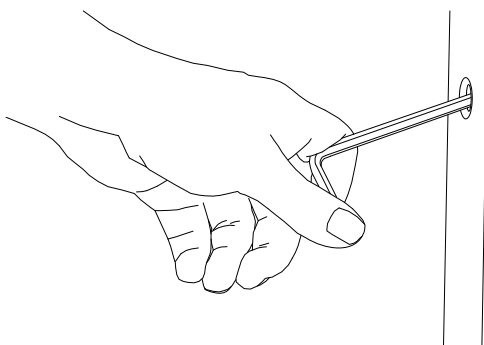

3. Tighten the frame adjusters clockwise, with a 5mm ball-ended Allen key, until the ends of the spreader plates are flat against the wall.

Access is gained through the countersunk holes in the jambs, angling the key 20° from horizontal.

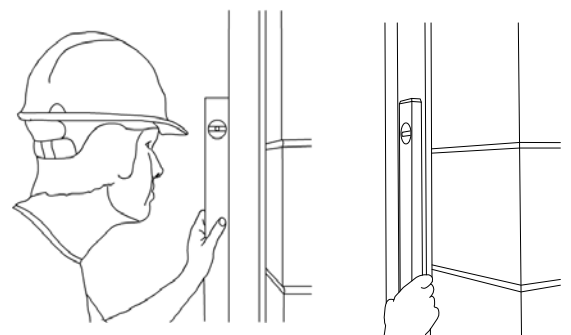

4. Ensure the frame is vertical, in both planes.

Warning: do not open the door until first fixings are in place, after step 5.

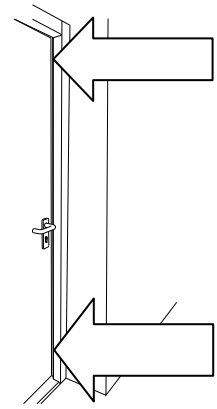
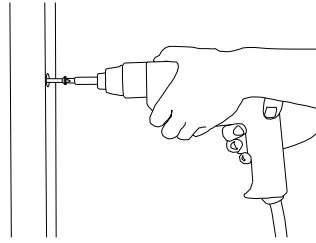
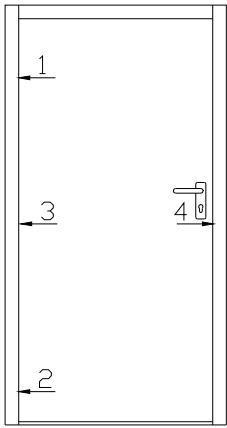

5. Using long countersunk frame fixings, first fix as shown, with 3 fixings in the hinge jamb and 1 in the lock jamb.

- For steel, use ITW Buildex TFL 100 or similar.

Vibration from a hammer drill can loosen the frame adjusting screws, so re-check tightness of the adjusters prior to inserting masonry fixings.

6. Open the door and discard the transit packings. With the door nearly closed, check the alignment between the lock edge of the door and the frame seal, at both the top and the bottom of the door.

Pivot the lock jamb about the central fixing to achieve an even gap between the face of the door and the frame seal.

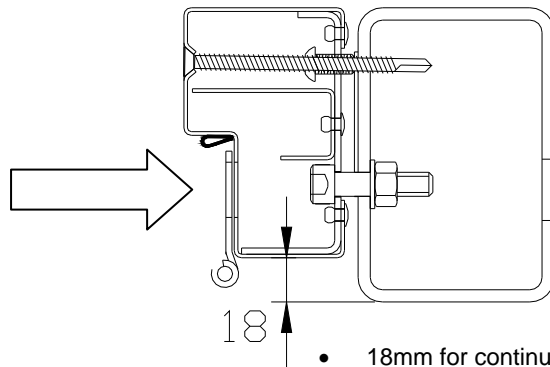
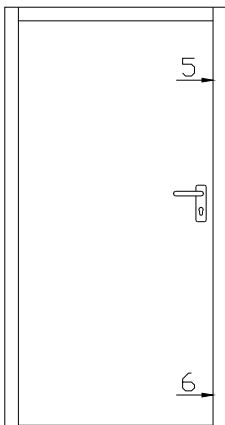

- 18mm for continuous hinge as shown
- 25mm for multiple VN5133 hinges

7. Close the door again, then fit the last 2 fixings into face 5 of the lock jamb.

8. Open the door fully, then tighten the frame adjusters in the reveals.

9. Using approved screws only, second fix through the access holes in the frame reveals.

- For steel, use M10x40 cap head socket screws grade 12.9, through fixed and secured with washers and hex nuts as shown.
- The same screws may also be blind fixed by tapping into the steel.

10. Fix threshold to floor with countersunk screws

- For steel, use ITW Buildex TFL 65 or similar.
- For concrete, use Rawl frame fixings 8x60 or similar.

12. Check operation of all locking mechanisms.

11. Adjust any door closers to suit the on-site requirements. Refer to separate instruction sheet for full details.

13. Apply mastic or flashings to seal frame to building.

14. Seal threshold to floor to avoid water ingress.